

# ANALOG OUTPUT

EXTRA DISTANCE	EXTRA DISTANCE	EXTRA DISTANCE	EXTRA DISTANCE
M12	M12	M18	M18
0 ... 6	0 ... 6	0 ... 10	0 ... 10

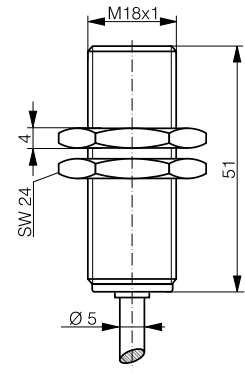
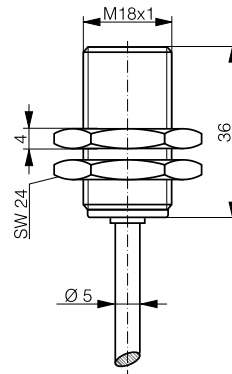
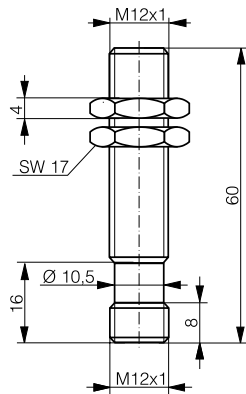
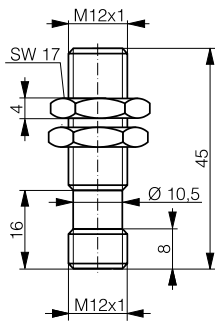

1,000 Hz (at s = 3 mm)	1,000 Hz (at s = 3 mm)	500 Hz (at s = 5 mm)	500 Hz (at s = 5 mm)
0 ... 5 V / 0 ... 10 V (-320)	0 ... 5 V / 0 ... 10 V (-390)	0 ... 5 V / 0 ... 10 V (-320)	0 ... 5 V / 0 ... 10 V (-390)
Chrome-plated brass	Chrome-plated brass	Chrome-plated brass	Chrome-plated brass
Connector S12	Connector S12	PUR cable	PUR cable
IP 67	IP 67	IP 67	IP 67
Quasi-embeddable	Quasi-embeddable	Quasi-embeddable	Quasi-embeddable
10 ... 30 / 15 ... 30 VDC (-320)	10 ... 30 / 15 ... 30 VDC (-390)	10 ... 30 / 15 ... 30 VDC (-320)	10 ... 30 / 15 ... 30 VDC (-390)
-25 ... +70°C / -13 ... +158°F	-25 ... +70°C / -13 ... +158°F	-25 ... +70°C / -13 ... +158°F	-25 ... +70°C / -13 ... +158°F
1 ... 5 mA (-120 only)	1 ... 5 mA / 4 ... 20 mA (-390)	1 ... 5 mA / 4 ... 20 mA (-320)	1 ... 5 mA / 4 ... 20 mA (-390)
<b>DW-AS-509-M12-120</b>	<b>DW-AS-509-M12</b>	<b>DW-AD-509-M18-120</b>	<b>DW-AD-509-M18</b>
<b>DW-AS-509-M12-320</b>			
	<b>DW-AS-509-M12-390</b>	<b>DW-AD-509-M18-320</b>	<b>DW-AD-509-M18-390</b>
			On request

Inductive

Photoelectric

Safety

RFID

Connectivity

Accessories

Glossary

Index

# ANALOG OUTPUT

## INDUCTIVE

FAMILY	EXTRA DISTANCE	EXTRA DISTANCE	EXTRA DISTANCE
HOUSING SIZE	M18	M18	M30
SENSING RANGE MM	0 ... 10	0 ... 20	0 ... 20

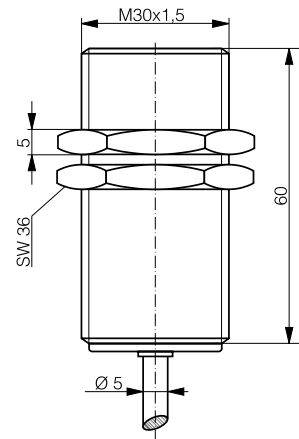
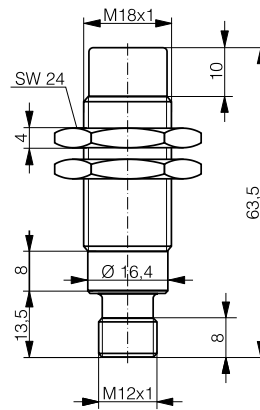
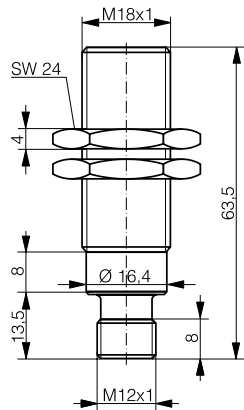

DATA			
Bandwidth (-3 dB)	500 Hz (at s = 5 mm)	250 Hz (at s = 10 mm)	200 Hz (at s = 10 mm)
Output voltage	0 ... 5 V / 0 ... 10 V (-390)	0 ... 5 V / 0 ... 10 V (-390)	0 ... 5 V / 0 ... 10 V (-390)
Housing material	Chrome-plated brass	Chrome-plated brass	Chrome-plated brass
Connection	Connector S12	Connector S12	PUR cable
Degree of protection	IP 67	IP 67	IP 67
Mounting	Quasi-embeddable	Non-embeddable	Quasi-embeddable
Supply voltage range	10 ... 30 / 15 ... 30 VDC (-390)	10 ... 30 / 15 ... 30 VDC (-390)	10 ... 30 / 15 ... 30 VDC (-390)
Ambient temperature range	-25 ... +70°C / -13 ... +158°F	-25 ... +70°C / -13 ... +158°F	-25 ... +70°C / -13 ... +158°F
Output current	1 ... 5 mA / 4 ... 20 mA (-390)	1 ... 5 mA / 4 ... 20 mA (-390)	1 ... 5 mA / 4 ... 20 mA (-390)
Outputs 0...5 V / 1...5 mA	<b>DW-AS-509-M18-002</b>	<b>DW-AS-519-M18-002</b>	<b>DW-AD-509-M30</b>
Outputs 0...10 V / 4...20 mA	<b>DW-AS-509-M18-390</b>	<b>DW-AS-519-M18-390</b>	<b>DW-AD-509-M30-390</b>
Other types available	On request	On request	On request