

# BASIC

EXTRA DISTANCE	CLASSICS	CLASSICS	CLASSICS
M8	□ 8 x 8	□ 8 x 8	□ 8 x 8
6	1.5	1.5	2

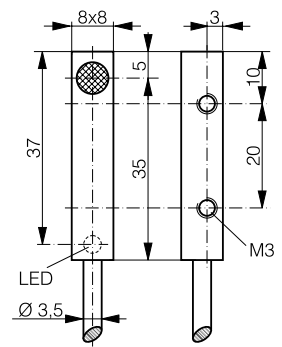
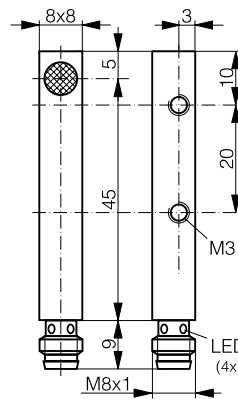
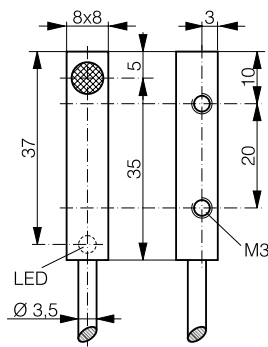
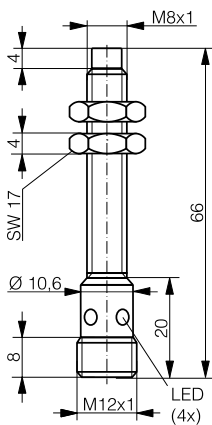

* IO-Link	IO-Link	IO-Link	IO-Link
Chrome-plated brass	Zamak	Zamak	Zamak
Connector S12	PVC cable	Connector S8	PVC cable
IP 67	IP 67	IP 67	IP 67
Non-embeddable	Embeddable	Embeddable	Embeddable
500 Hz	3500 Hz	3500 Hz	5000 Hz
10 ... 30 VDC	10 ... 30 VDC	10 ... 30 VDC	10 ... 30 VDC
-25 ... +70°C / -13 ... +158°F	-25 ... +70°C / -13 ... +158°F	-25 ... +70°C / -13 ... +158°F	-25 ... +70°C / -13 ... +158°F
≤ 200 mA	≤ 200 mA	≤ 200 mA	≤ 200 mA
<b>DW-AS-513-M8</b>	<b>DW-AD-603-C8</b>	<b>DW-AS-603-C8-001</b>	<b>DW-AD-623-C8</b>
<b>DW-AS-511-M8</b>	<b>DW-AD-601-C8</b>	<b>DW-AS-601-C8-001</b>	<b>DW-AD-621-C8</b>
PNP NC, NPN NC	PNP NC, NPN NC	PNP NC, NPN NC	PNP NC, NPN NC

Inductive

Photoelectric

Safety

RFID

Connectivity

Accessories

Glossary

Index

# BASIC

## INDUCTIVE

FAMILY	CLASSICS	EXTRA DISTANCE	EXTRA DISTANCE
HOUSING SIZE	□ 8 x 8	□ 8 x 8	□ 8 x 8
OPERATING DISTANCE MM	2	3	3

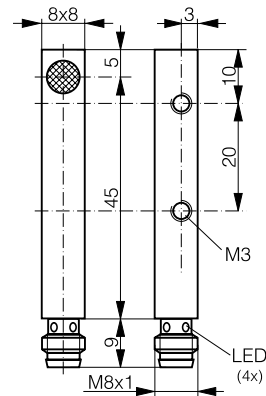
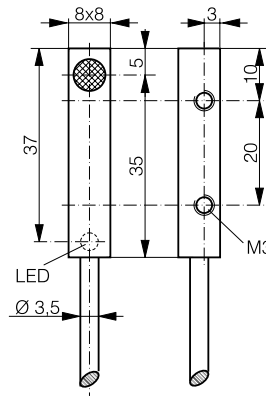
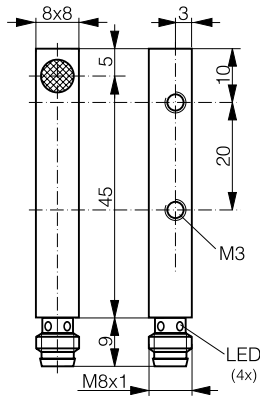

\* IO-Link available from Q4/18

DATA	IO-Link	*  IO-Link	*  IO-Link
Housing material	Zamak	Zamak	Zamak
Connection	Connector S8	PVC cable	Connector S8
Degree of protection	IP 67	IP 67	IP 67
Mounting	Embeddable	Quasi-embeddable	Quasi-embeddable
Max. switching frequency	5000 Hz	1000 Hz	1000 Hz
Supply voltage range	10 ... 30 VDC	10 ... 30 VDC	10 ... 30 VDC
Ambient temperature range	-25 ... +70°C / -13 ... +158°F	-25 ... +70°C / -13 ... +158°F	-25 ... +70°C / -13 ... +158°F
Output current	≤ 200 mA	≤ 200 mA	≤ 200 mA
PNP NO	<b>DW-AS-623-C8-001</b>	<b>DW-AD-503-C8</b>	<b>DW-AS-503-C8</b>
NPN NO	<b>DW-AS-621-C8-001</b>	<b>DW-AD-501-C8</b>	<b>DW-AS-501-C8</b>
Other types available	PNP NC, NPN NC	PNP NC, NPN NC	PNP NC, NPN NC