

HIGH PRESSURE

EXTRA DISTANCE	EXTRA DISTANCE	EXTRA DISTANCE	EXTRA DISTANCE
M5 (P5)	M5 (P5)	M8 (P8)	M12 (P12)
1	1	1.5	1.5 (2.5)

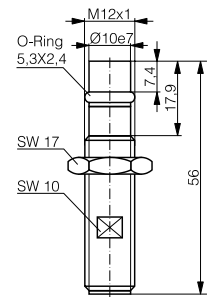
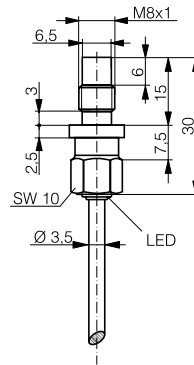
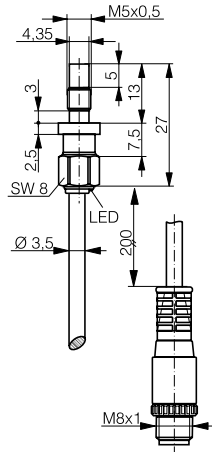
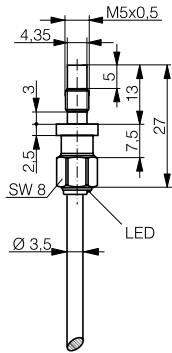

* IO-Link available from Q4/18

* IO-Link	* IO-Link	* IO-Link	* IO-Link
Ceramic ZrO ₂	Ceramic ZrO ₂	Ceramic ZrO ₂	Ceramic ZrO ₂
500 bar	500 bar	500 bar	500 bar
1000 bar	1000 bar	1000 bar	1000 bar
Stainless steel V4A / AISI 316L	Stainless steel V4A / AISI 316L	Stainless steel V4A / AISI 316L	Stainless steel V2A
PUR cable	PUR cable / Connector S8	PUR cable	Connector S12
IP 68	IP 68	IP 68	IP 68
Embeddable	Embeddable	Embeddable	Embeddable
1000 Hz	1000 Hz	800 Hz	600 Hz
10 ... 30 VDC	10 ... 30 VDC	10 ... 30 VDC	10 ... 30 VDC
-25 ... +100°C / -13 ... +212°F	-25 ... +100°C / -13 ... +212°F	-25 ... +100°C / -13 ... +212°F	-25 ... +100°C / -13 ... +212°F
≤ 200 mA	≤ 200 mA	≤ 200 mA	≤ 200 mA
DW-AD-503-P5	DW-AV-503-P5-276	DW-AD-503-P8	
DW-AD-501-P5	DW-AV-501-P5-276	DW-AD-501-P8	
			DW-AS-503-P12-630
			DW-AS-504-P12-630
			DW-AS-523-P12-630
PNP NC, NPN NC	PNP NC, NPN NC	PNP NC, NPN NC	NPN NO, NPN NC

HIGH PRESSURE

FAMILY

EXTRA DISTANCE

EXTRA DISTANCE

EXTRA DISTANCE

HOUSING SIZE

M12 (P12)

M12 (P12)

M12 (P12)

OPERATING DISTANCE MM

1.5 (2.5)

1.5 (2.5)

1.5 (2.5)

INDUCTIVE

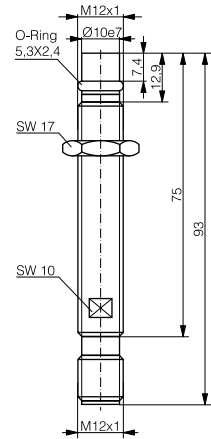
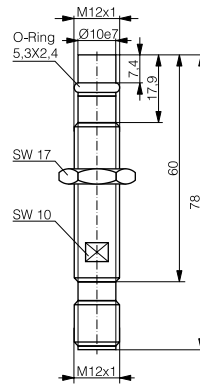
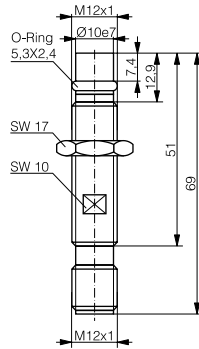

* IO-Link available from Q4/18

DATA	* IO-Link	* IO-Link	* IO-Link
Sensing face material	Ceramic ZrO ₂	Ceramic ZrO ₂	Ceramic ZrO ₂
Operating pressure	500 bar	500 bar	500 bar
Peak pressure	1000 bar	1000 bar	1000 bar
Housing material	Stainless steel V2A	Stainless steel V2A	Stainless steel V2A
Connection	Connector S12	Connector S12	Connector S12
Degree of protection	IP 68	IP 68	IP 68
Mounting	Embeddable	Embeddable	Embeddable
Max. switching frequency	600 Hz	600 Hz	600 Hz
Supply voltage range	10 ... 30 VDC	10 ... 30 VDC	10 ... 30 VDC
Ambient temperature range	-25 ... +100°C / -13 ... +212°F	-25 ... +100°C / -13 ... +212°F	-25 ... +100°C / -13 ... +212°F
Output current	≤ 200 mA	≤ 200 mA	≤ 200 mA
PNP NO	DW-AS-503-P12	DW-AS-503-P12-627	DW-AS-503-P12-621
NPN NO	DW-AS-501-P12	DW-AS-501-P12-627	DW-AS-501-P12-621
Other types available	PNP NC, NPN NC, 2.5 mm operating distance	PNP NC, NPN NC, 2.5 mm operating distance	PNP NC, NPN NC, 2.5 mm operating distance

HIGH PRESSURE

EXTRA DISTANCE	EXTRA DISTANCE	FULL INOX	EXTRA DISTANCE
M12 (P12)	M12 (P12)	M12 (P12)	M14 (P20)
1.5 (2.5)	1.5 (2.5)	1.5	3

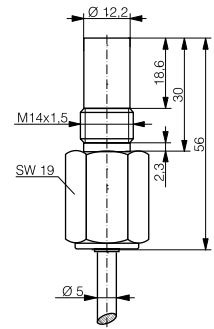
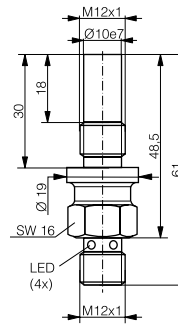
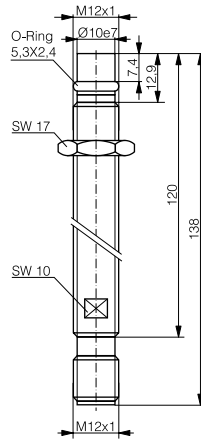
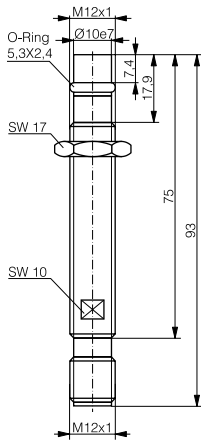

* IO-Link	* IO-Link	IO-Link	* IO-Link
Ceramic ZrO ₂	Ceramic ZrO ₂	Stainless steel V4A / AISI 316L	Ceramic ZrO ₂
500 bar	500 bar	500 bar	500 bar
1000 bar	1000 bar	800 bar	1000 bar
Stainless steel V2A	Stainless steel V2A	Stainless steel V4A / AISI 316L	Stainless steel V4A / AISI 316L
Connector S12	Connector S12	Connector S12	PUR cable
IP 68	IP 68	IP 68 / IP 69K	IP 68
Embeddable	Embeddable	Embeddable	Embeddable
600 Hz	600 Hz	850 Hz	500 Hz
10 ... 30 VDC	10 ... 30 VDC	10 ... 30 VDC	10 ... 30 VDC
-25 ... +100°C / -13 ... +212°F	-25 ... +100°C / -13 ... +212°F	-25 ... +85°C / -13 ... +185°F	-25 ... +100°C / -13 ... +212°F
≤ 200 mA	≤ 200 mA	≤ 200 mA	≤ 200 mA
DW-AS-503-P12-635	DW-AS-503-P12-622	DW-LS-703-P12G	DW-AD-503-P20
DW-AS-501-P12-635	DW-AS-501-P12-622		DW-AD-501-P20
PNP NC, NPN NC, 2.5 mm operating distance	PNP NC, NPN NC, 2.5 mm operating distance	PUR cable, pigtail	PNP NC, NPN NC

Inductive

Photoelectric

Safety

RFID

Connectivity

Accessories

Glossary

Index